

# SMB Conn. Series

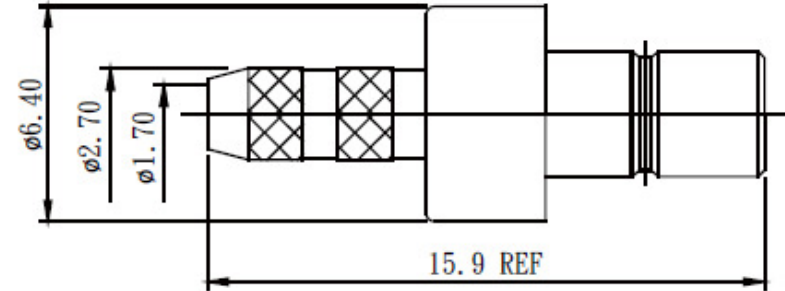

SMB002-M  GW-L  
5:50 Ω 7:75 Ω

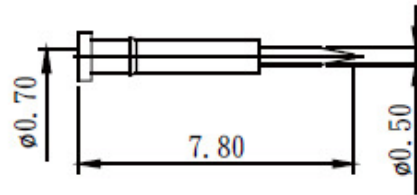
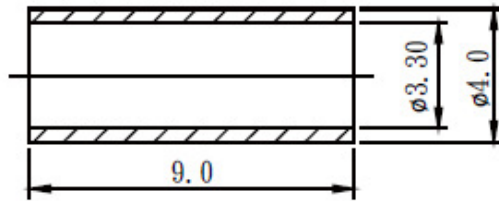

| NO | DESCRIPTION | MATERIAL | FINISH | QTY |
|----|-------------|----------|--------|-----|
| 5  | FERRULE     | BRASS    | GOLD   | 1   |
| 4  | DIELECTRIC  | TEFLON   | NONE   | 1   |
| 3  | PIN         | BRASS    | GOLD   | 1   |
| 2  | BODY        | BRASS    | GOLD   | 1   |
| 1  | BODY        | BRASS    | GOLD   | 1   |

|   |                       |                       |
|---|-----------------------|-----------------------|
| IMPEDANCE                                 | 50 OHM                |                       |
| FREQUENCY                                 | 0-4 GHz               |                       |
| DIELECTRIC WITHSTANDING VOLTAGE 50 Hz RMS | 750V                  | 1000V                 |
| WORKING VOLTAGE 50 Hz RMS                 | 250V                  | 335V                  |
| WORKING VOLTAGE DC                        | 350V                  | 450V                  |
| INSULATION RESISTANCE                     | 1000 MEGOHMS MIN      |                       |
| CONTACT RESISTANCE                        | INNER CONDUCTOR       | ≦ 3 MILLIOHMS         |
|   | OUTER CONDUCTOR       | ≦ 0.5 MILLIOHMS       |
| INSERTION LOSS (dB MAX.)                  | STRAIGHT CONNECTOR    | .15 dB MAX. AT 1.0GHz |
|   | RIGHT ANGLE CONNECTOR | .30 dB MAX. AT 1.0GHz |

**TOPTEK**  
HARDWARE ELECTRONIC COMPONENTS



[www.toptek-co.com](http://www.toptek-co.com)